

**SPECIFICATIONS:**

Aluminum Profile with Diffuser  
 Shallow Recess Channel  
 Length: Varies  
 Overall Recess Width: 0.67" / 17.1mm  
 Overall Width w/ Flange: 0.91" / 23.1mm  
 Inside Width: 0.48" / 12.2mm  
 Depth: 0.33" / 12.2mm  
 Application: Suitable for 12mm LED Ribbon  
 Included: 1 x Feed End Cap  
           1 x Cover End Cap  
           1 x Diffuser Lens

**PRODUCT BENEFITS:**

Frosted diffuser (lens) reduces the appearance of LED dots on ribbon in visible areas.

Frosted diffuser (lens) installs for the top of the channel snapping into place making installs easy especially in tight spaces.

Creates a finished seamless look for all your LED ribbon installation applications.

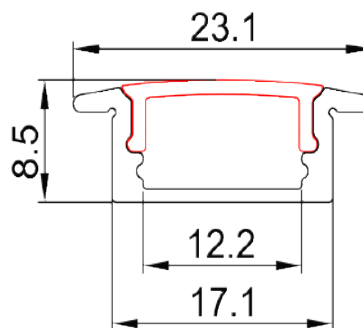
**PRODUCT DIMENSIONS:**

## RECOMMENDED COMPATIBLE PRODUCTS:

---

Suitable for use with all Glimmer Lighting 12V LED Ribbon.

## ORDERING INFORMATION

---

1. Select Channel:

**GL-1204RECS-**(select colour) **-** (select length)

- |           |           |                                      |
|-----------|-----------|--------------------------------------|
| 1. Colour | <b>WH</b> | - Matte White Finish with White Lens |
|           | <b>BK</b> | - Matte Black Finish with Black Lens |
| 2. Length | <b>1M</b> | - 1 Meters / 39.4"                   |
|           | <b>2M</b> | - 2 Meters / 78.7"                   |